



## PRODUCT DATA SHEET

PAGE 1/2

MSDR12 Ceiling connection column

Item no. MM03000332



### TECHNICAL DATA

Dimensions:	120x3000mm (DxH)
Ingress protection:	IPX0
Protection class:	I
Material:	Aluminum, anodized E6/EV1
Color:	silver
Hole patterns:	4 x Hole pattern no. 1.1 for standard devices for two double frames
Weight:	approx. 12kg



**PRODUCT DATA SHEET**  
PAGE 2/2

**DIMENSIONS**

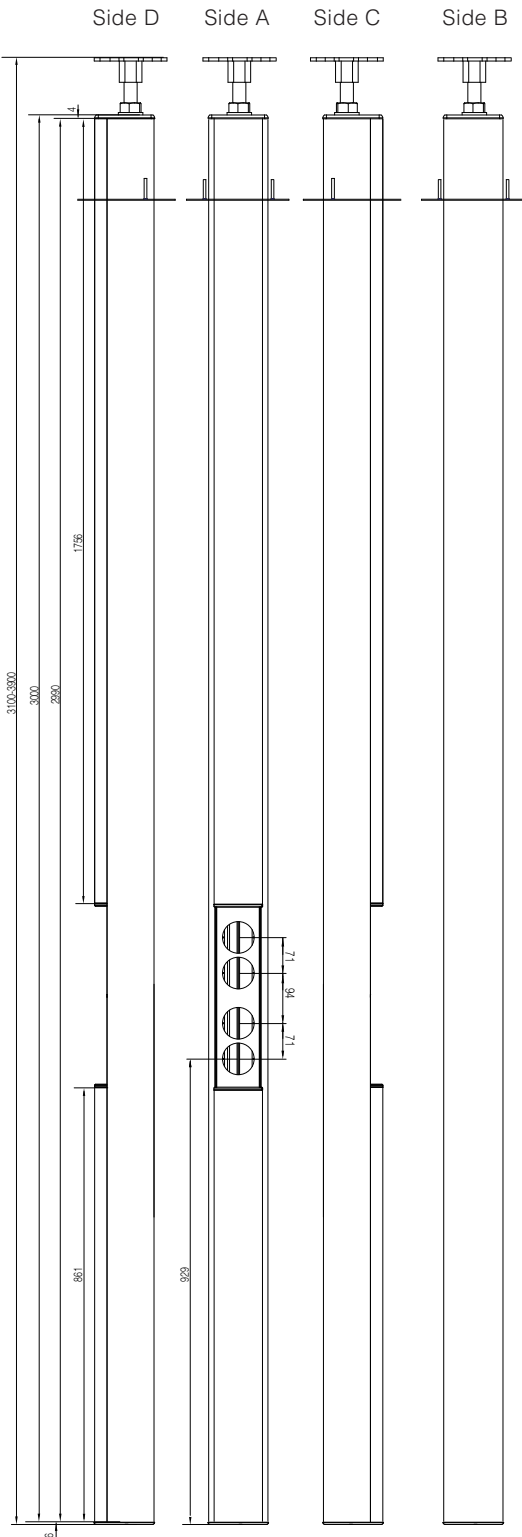

**HOLE PATTERN**

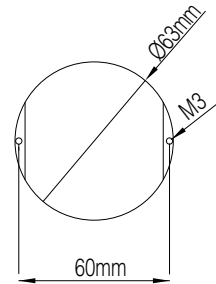

All dimensions in millimeters.

Modifications and errors excepted. No liability accepted for printing errors.  
Our terms of delivery and payment apply.