



PRODUCT DATA SHEET

PAGE 1/2

MS18 Electrical connection column

Item no. MD70800155C



TECHNICAL DATA

Dimensions:	180x100x800mm (WxDxH)
Ingress protection:	IPX4
Protection class:	I
Material:	Aluminum, anodized E6/EV1
Color:	anthracite
Aussparungen/Equipment:	2 x Hole pattern no. 13.1 Ø68mm for cavity wall boxes for double frame 1 x Drinking water connection 1/2"
Light module:	LED-Orientation light - with inserted LED light strip, water resistant shed - LED driver 24V - pre-wired on connection clamps 2x4qmm
Weight:	approx. 6,7kg



MOSER SYSTEMELEKTRIK GMBH

CONNECTION COLUMNS ENERGY BOLLARDS
UNDERGROUND DISTRIBUTORS STANDING CABINETS
KERNERSTRASSE 15 74405 GAILDORF GERMANY

PRODUCT DATA SHEET

PAGE 2/2

DIMENSIONS

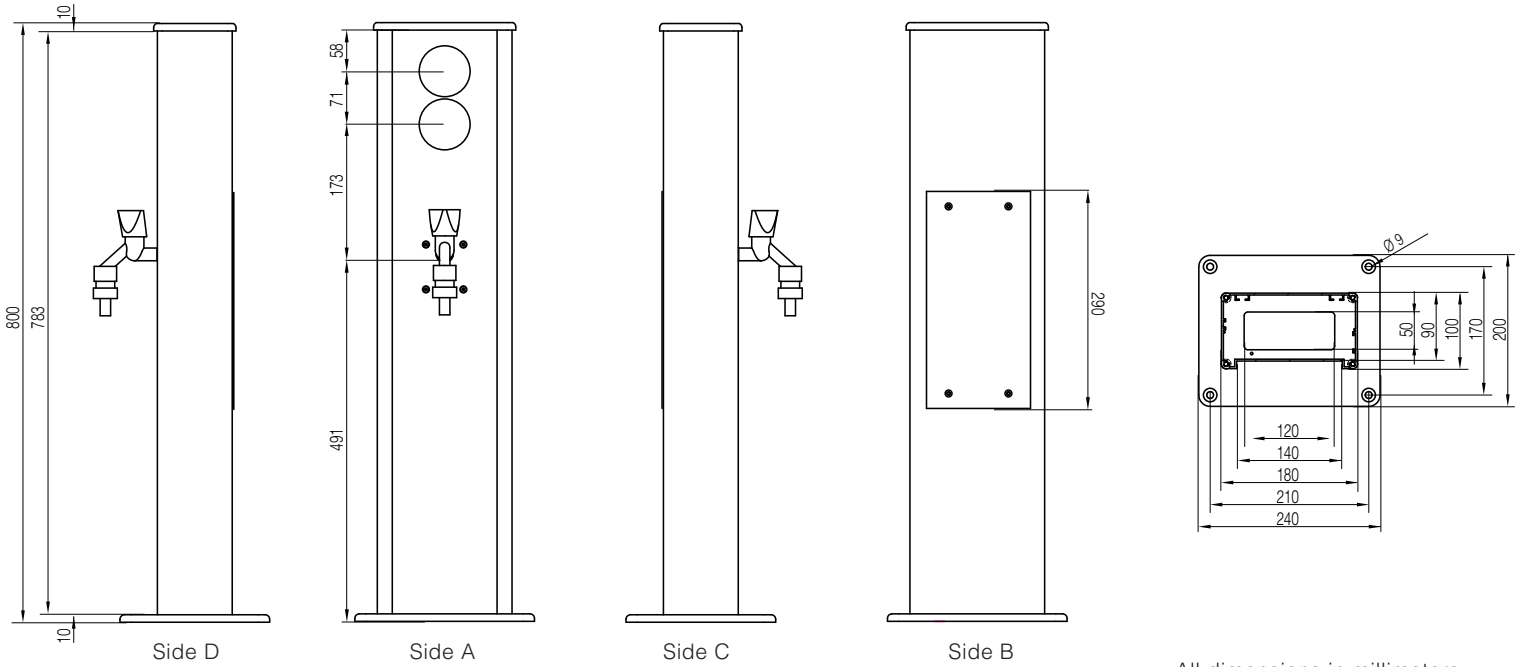

All dimensions in millimeters.

HOLE PATTERN

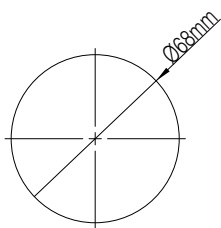

WIRING DIAGRAM

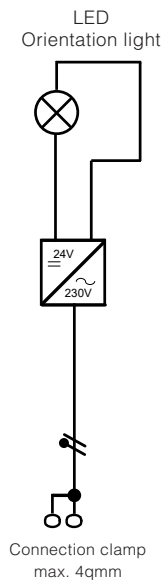

Modifications and errors excepted. No liability accepted for printing errors.
Our terms of delivery and payment apply.